

The **San Jose Bioscience Incubator and Innovation Center** will be **open** for operation in **June 2004**. For more information or to reserve space in the Incubator, please contact:

**Ru Weerakoon**

Director of Industrial Development  
 ru.weerakoon@sanjoseca.gov  
 Phone: 408.794.1170  
 www.sjredevelopment.org  
 www.sjsitefinder.com  
 www.sjeconomy.com

**SAN JOSE REDEVELOPMENT AGENCY**

50 W. San Fernando Street, Suite 900,  
 San Jose, CA 95113

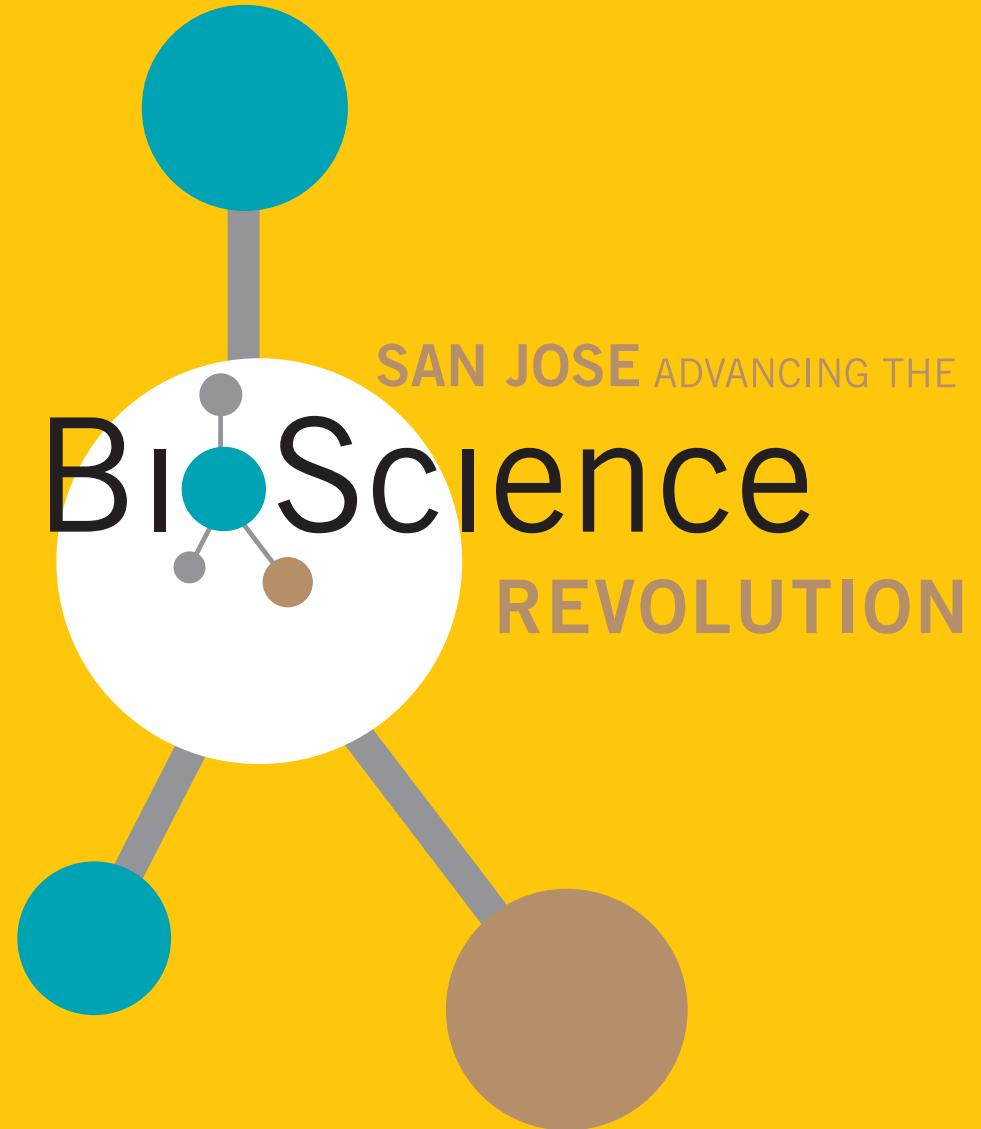

## San Jose Bioscience Incubator and Innovation Center

The San Jose Redevelopment Agency is proud to announce that construction is currently in progress on the **San Jose Bioscience Incubator and Innovation Center**.

The incubator is located in the **Edenvale Technology Park** in South San Jose, and is easily accessible from Hwy 101 and Rte 85. Edenvale comprises **2,312 acres**, with **8 million square feet of R&D, office, and manufacturing space**. Over 390 driving industry companies including Stryker Endoscopy, Innovative Robotics, Power Integration, Clinimetrics, IBM, Symbol Technologies, Celestica, Lynux Works, Ciena, Intel, Ionics, Hitachi, Solectron, Electroglas, Northrop Grumman, M/A-Com Tyco Electronics, and Jabil Circuits operate in Edenvale and employ over 15,000 San Jose and Silicon Valley residents.

Edenvale is located **12 minutes** south of **Downtown San Jose**, **20 minutes** south of the **Mineta San Jose International Airport**, and within **30 minutes or less** from San Jose State University, Stanford University, Santa Clara University, UC Santa Cruz, and numerous research institutions and community colleges.

## Layout of Incubator

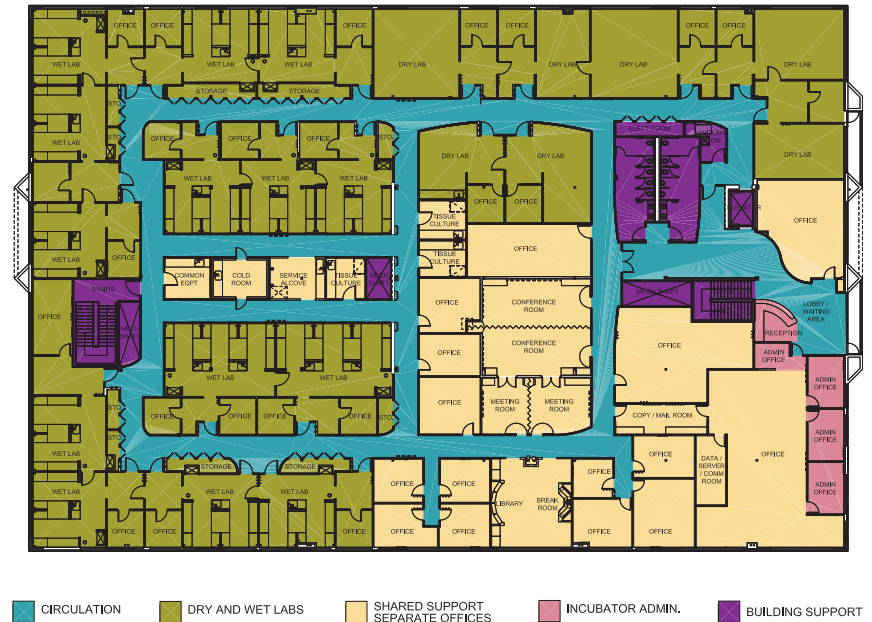

## Features & Amenities:

- ✓ 36,500 square feet
- ✓ 14 Wet Labs
- ✓ 7 Dry Labs
- ✓ 13 Offices
- ✓ 3 Tissue Culture Facilities
- ✓ 4 Conference/Meeting Rooms
- ✓ 1 Common Equipment Room
- ✓ Library, Data Room
- ✓ Kitchen, Break Rooms
- ✓ Reception
- ✓ Material Storage
- ✓ Shipping and Receiving

## Incubator Services

- ✓ On site Management Team
- ✓ Start-up Assistance Programs
- ✓ Bioscience Support Services
- ✓ Educational and Mentoring Programs
- ✓ Networking Opportunities
- ✓ Technology Transfer Services
- ✓ Commercialization Services
- ✓ Flexible, Affordable Space
- ✓ Business Resources
- ✓ Links to Investment Community

## Equipment List

- ✓ Laminar Flow Hood
- ✓ Autoclave/Sterilizer
- ✓ Ice Machine
- ✓ Washer, Dryer and Dishwasher
- ✓ Milli-Q
- ✓ DI Central System
- ✓ Dry Ice Chest
- ✓ Centrifuge
- ✓ Incubator
- ✓ Local Area Network and T1 services

